



HANSA**UNITA**

Installation and maintenance guide



4-6



7-10



11-12

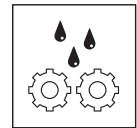

13-17



18



5813 0101

I (ISO 3822)
EN 1111
100 - 1000 kPa
0.17 l/s (Eco)
0.32 l/s (300 kPa)
max. +80°C

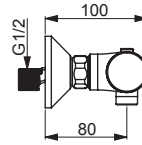
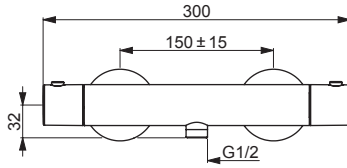

mpi.hansa.com/58130101

5813 0001

I (ISO 3822)
EN 1111
100 - 1000 kPa
0.32 l/s (300 kPa)
130 kPa (0.2 l/s)
max. +80°C

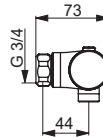
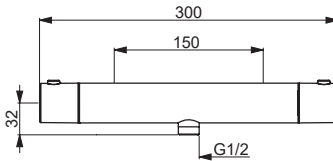

mpi.hansa.com/58130001

5837 2101

I (ISO 3822)
EN 1111
100 - 1000 kPa
0.34 / 0.32 l/s (300 kPa)
max. +80°C

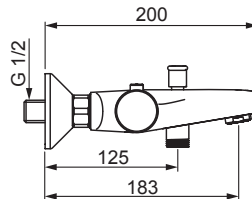
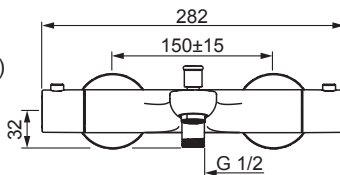

mpi.hansa.com/58372101



5814 9103

I (ISO 3822)
EN 1111, EN 1112, EN 1113
100 - 1000 kPa
0.20 / 0.20 l/s (300 kPa)
300 kPa (0.2 l/s)
max. +65°C

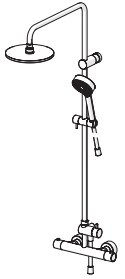
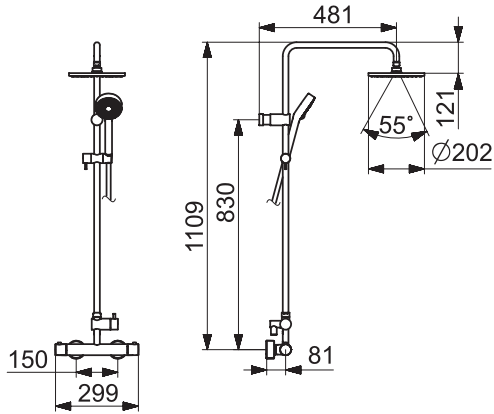

mpi.hansa.com/58149103

5814 9113 0067

I (ISO3822)
EN 1111, EN 1112, EN 1113
100 - 1000 kPa
0.20 / 0.20 l/s (300 kPa)
300 kPa (0.2 l/s)
max. +65°C

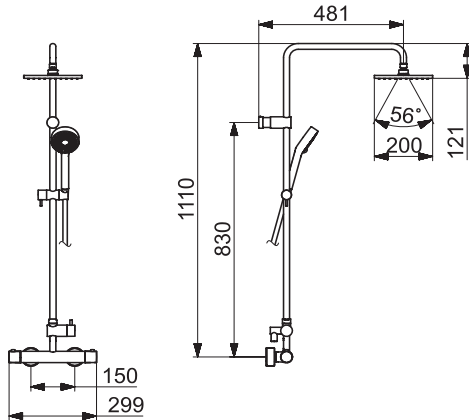

mpi.hansa.com/581491130067



4813 0131

EN 1111, EN 1112, EN 1113
 100 - 1000 kPa
 0.20 l/s (300 kPa)
 max. +80°C

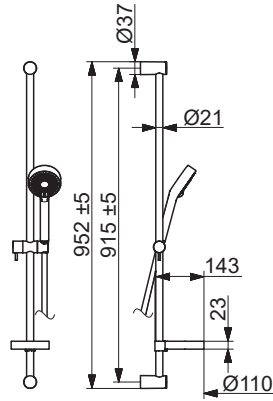
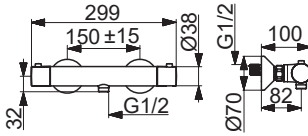

mpi.hansa.com/48130131

4813 0121

EN 1111, EN 1112, EN 1113
 100 - 1000 kPa
 0.20 l/s (300 kPa)
 max. +80°C

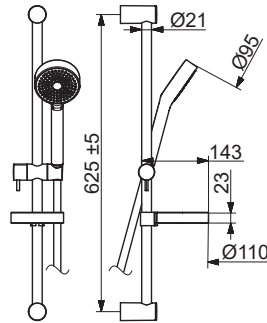
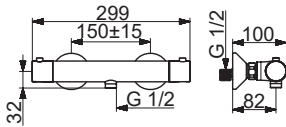

mpi.hansa.com/48130121

4837 2131

EN 1111, EN 1112, EN 1113
 100 - 1000 kPa
 max. +80°C

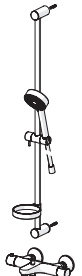
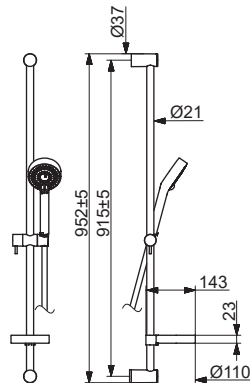
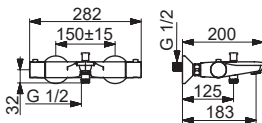

mpi.hansa.com/48372131

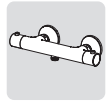
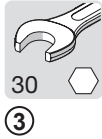
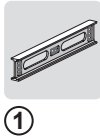

max.
1600 kPa

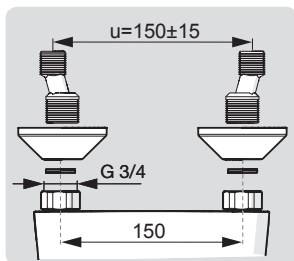
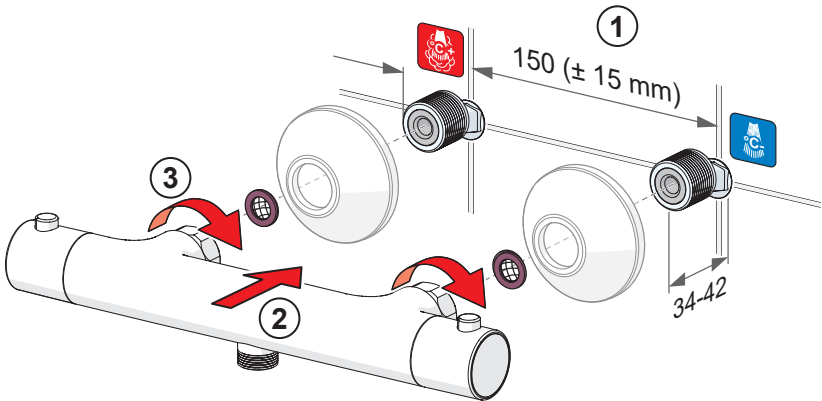
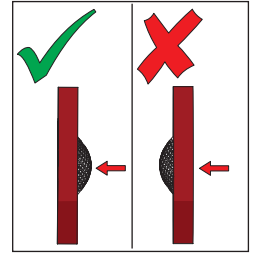

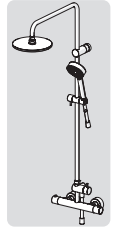
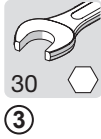
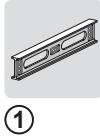
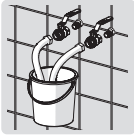
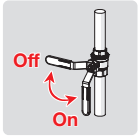

1

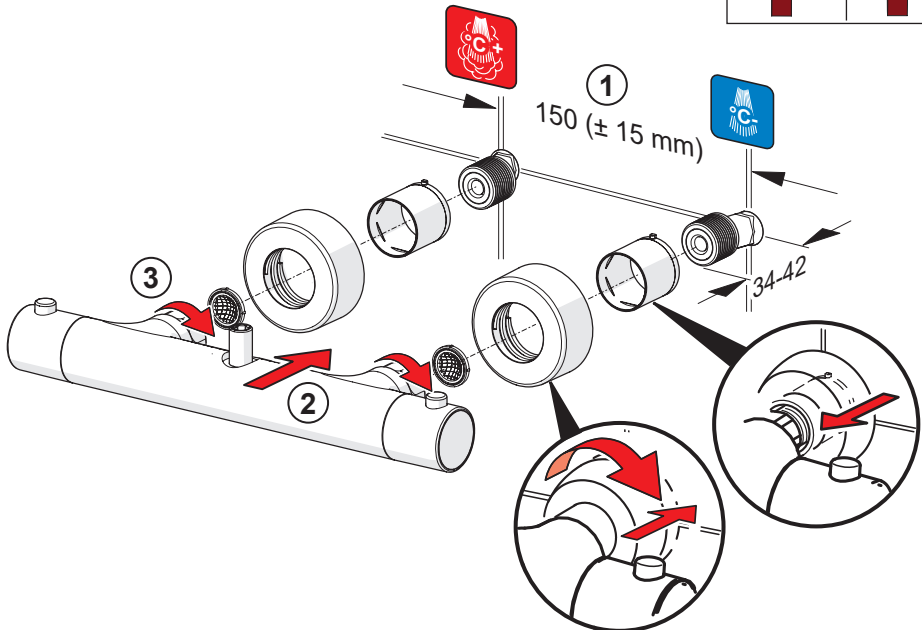
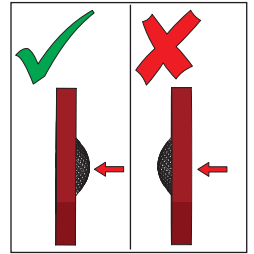

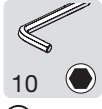

④

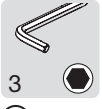

⑤

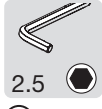

⑥

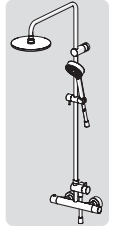

②

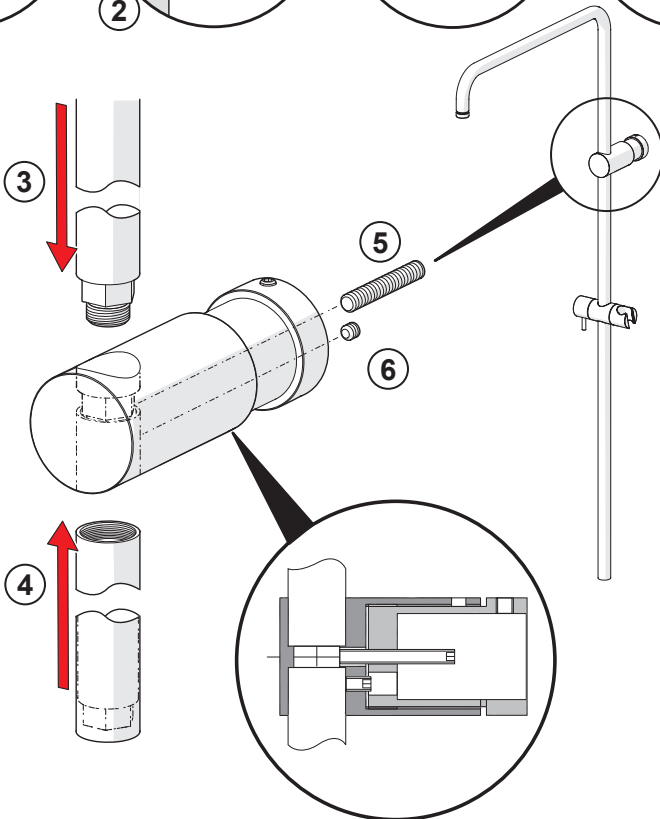
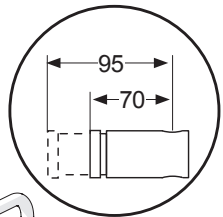
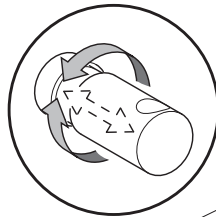
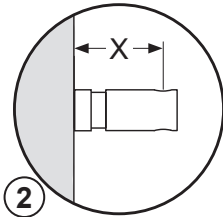
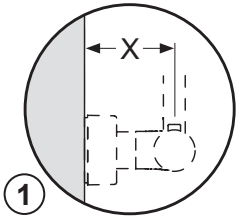



1



4



5



6



3

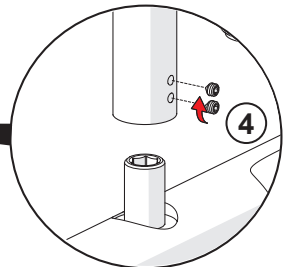
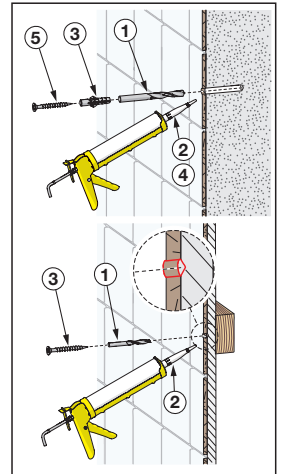
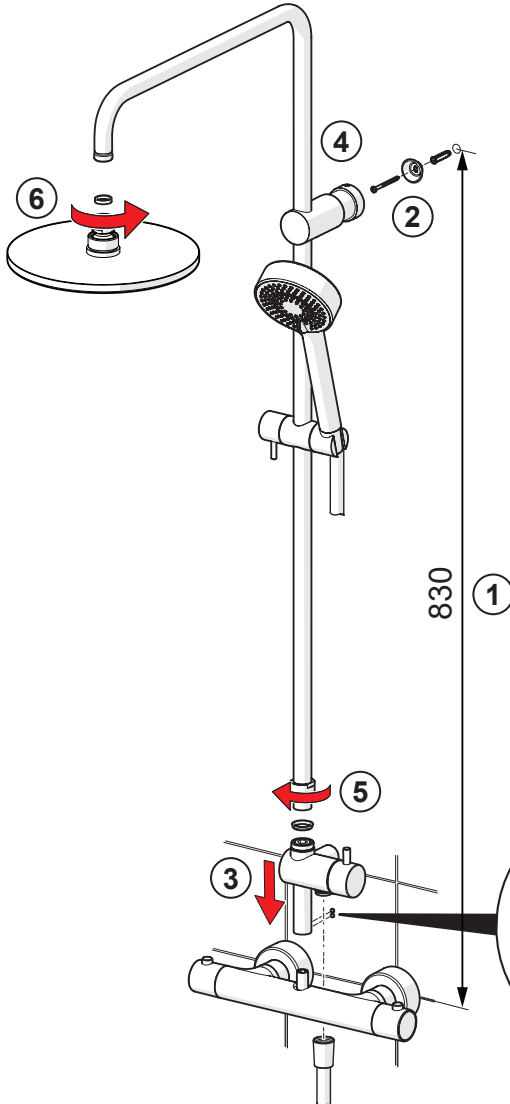

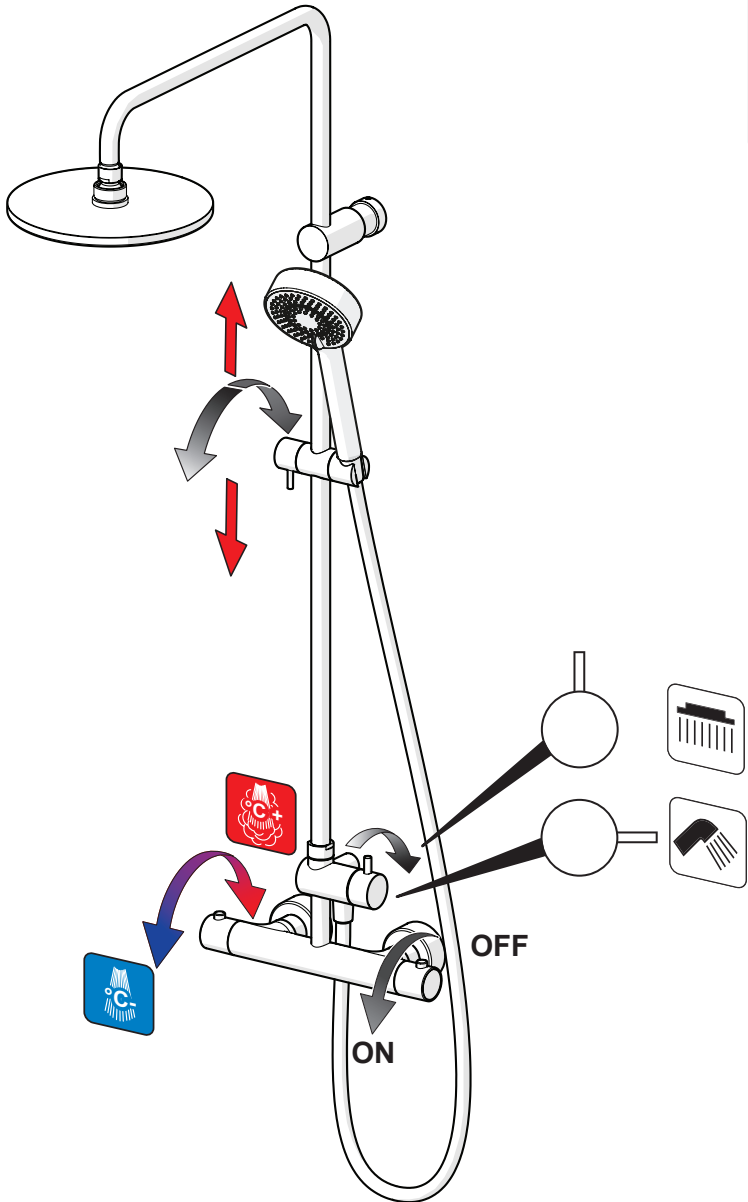
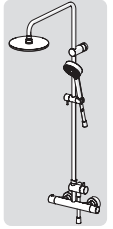

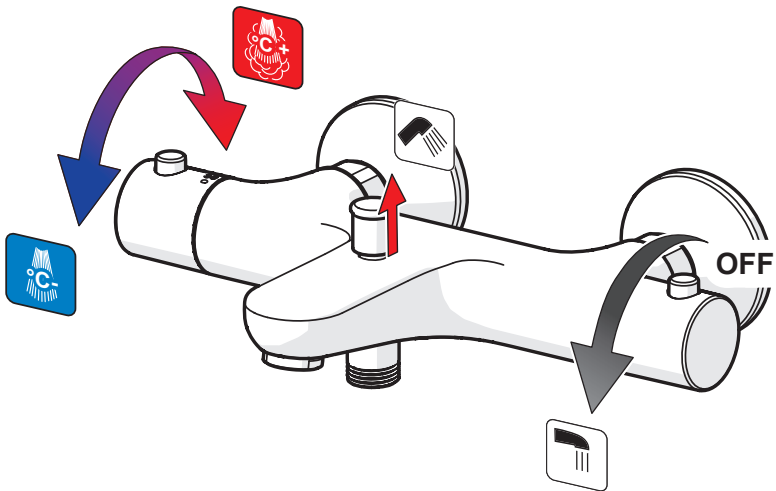
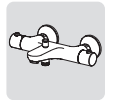
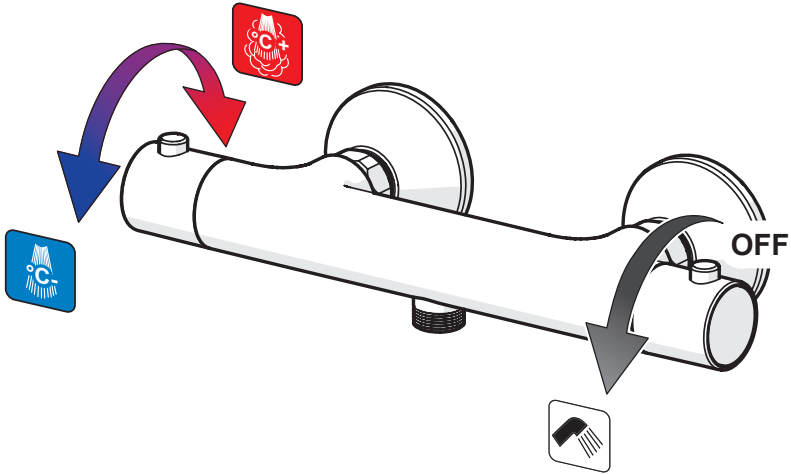
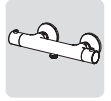

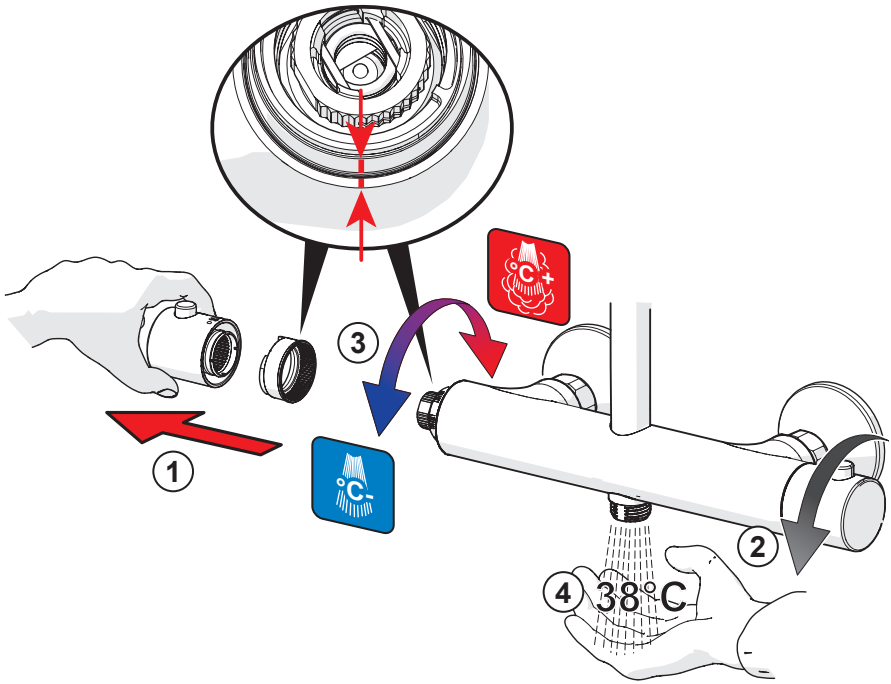

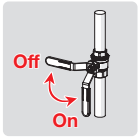

①

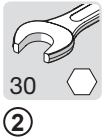

②



④

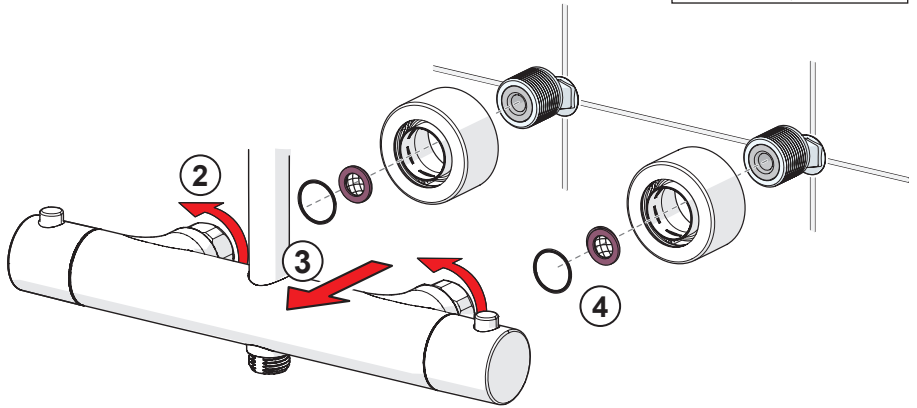
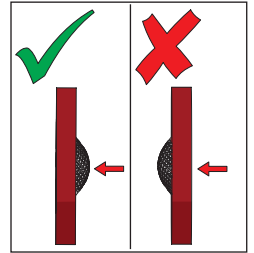

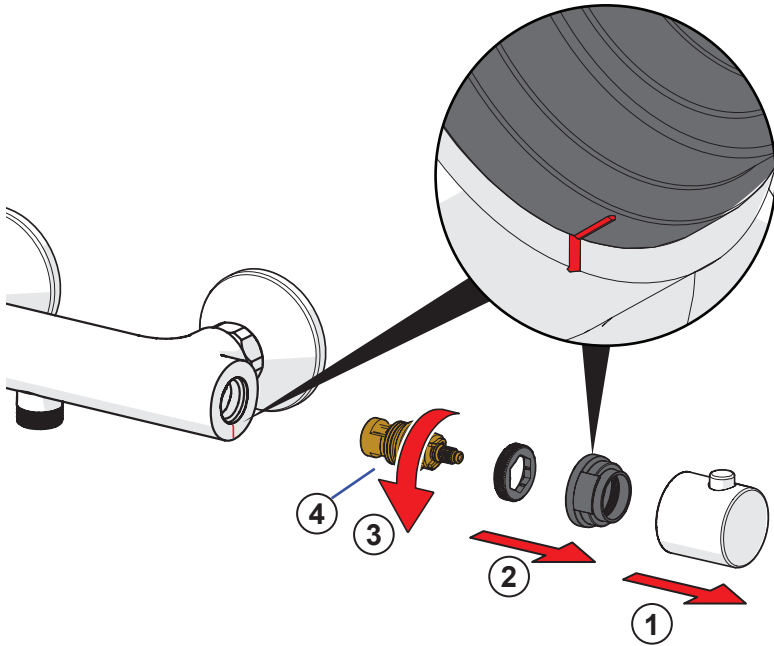
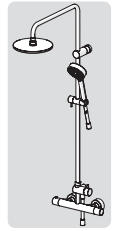
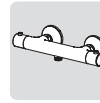
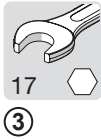
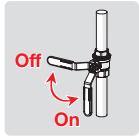

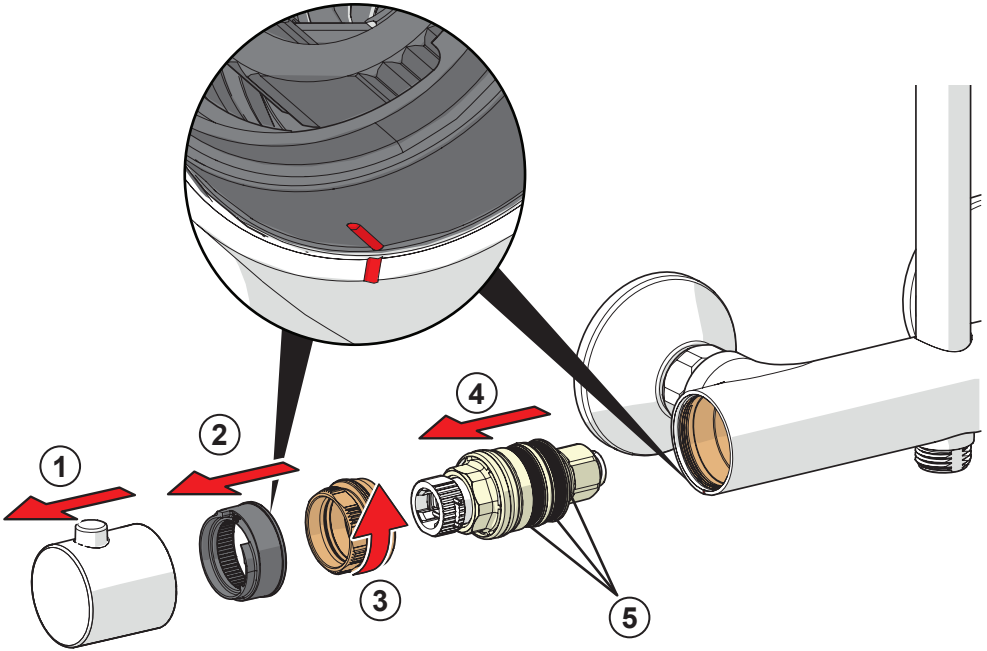
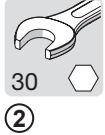
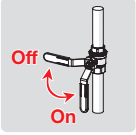



①

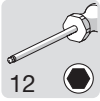

③

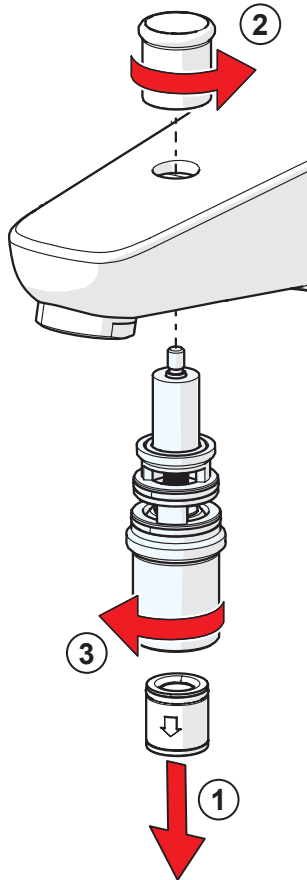
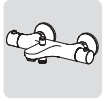

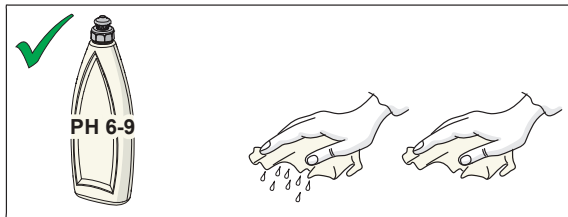
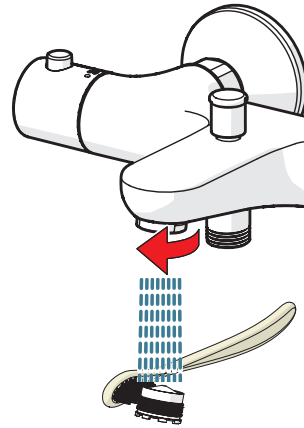
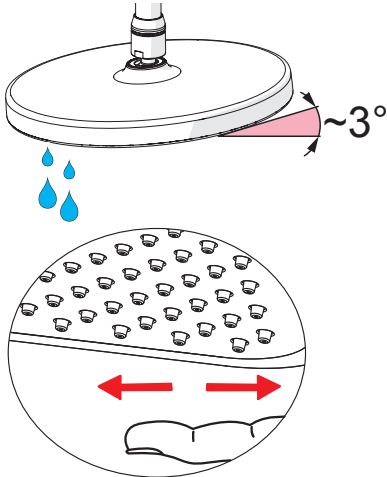
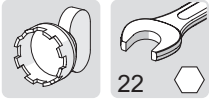

cleaning.hansa.com

Oras Group is a powerful European provider of sanitary fittings: the market leader in the Nordics and a leading company in Continental Europe. The company's mission is to make the use of water easy and sustainable and its vision is to become the European leader of advanced sanitary fittings. Oras Group has two strong brands: Oras and Hansa.

The Group's head office is located in Rauma, Finland, and the Group has three manufacturing sites: Kralovice (Czech Republic), Olesno (Poland) and Rauma (Finland). Oras Group employs approximately 1,200 people in twenty countries. Oras Group is owned by Oras Invest, a family company and an industrial owner.

HANSA Armaturen GmbH
P. O. BOX 81 02 40
D-70519 Stuttgart
Sigmaringer Strasse 107
D-70567 Stuttgart
Tel.: +49 711 16 14 0
Fax: +49 711 16 14 368
info@hansa.de
www.hansa.com



943239D-03-21